

BRUNTON

RESIDENTIAL



RIVER MEADOW, WARK, NE48

£429,950

BRUNTON

RESIDENTIAL





BRUNTON

RESIDENTIAL



BRUNTON

RESIDENTIAL



NEWLY BUILT FAMILY HOME - FOUR BEDROOMS - OPEN VIEWS - GARAGE & DRIVEWAY
Brunton Residential are delighted to offer for sale this superb four bedroom home located on River Meadows within Wark, just outside of Hexham. The Lily, built by Cussins, consists of four bedrooms, a lounge and separate snug. The accommodation offers a luxury finish and has some stunning views of the Northumberland countryside to the rear.

BRUNTON

RESIDENTIAL

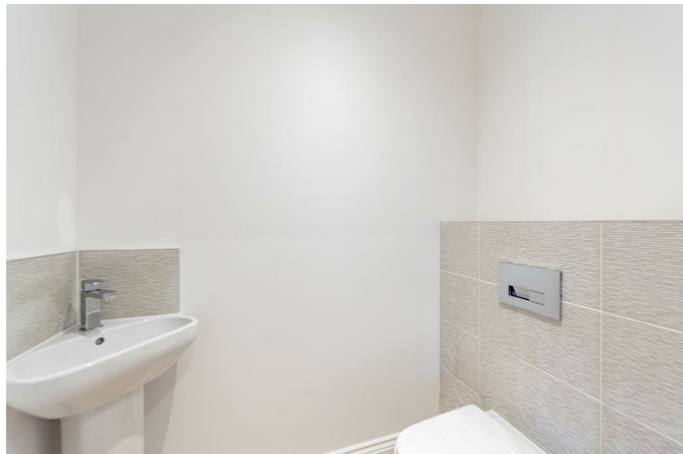

BRUNTON

RESIDENTIAL

Accommodation briefly comprises; an entrance hallway with staircase to first floor and G/F W/C. There is a door to a spacious lounge which has open plan access to the full width kitchen area. The kitchen provides a range of areas for food preparation and dining, it offers a range of wall and floor units with coordinated work surfaces and fitted appliances. also on the ground floor is a fitted utility room which provides side door access to the driveway and finally a small snug presents a perfect TV room or home office.

The first floor includes a substantial master bedroom with stylish ensuite shower room, three further bedrooms and a tiled family bathroom.

Externally there is a town garden to the front which is laid mainly to lawn and includes pathway access to the property. The rear of the property consists of a lawned garden with paved sun terrace. To rear is possibly some of the most tranquil views we have presented.



BRUNTON

RESIDENTIAL

TENURE : Freehold

LOCAL AUTHORITY :

COUNCIL TAX BAND : New Build

EPC RATING :

SERVICES :

New Build

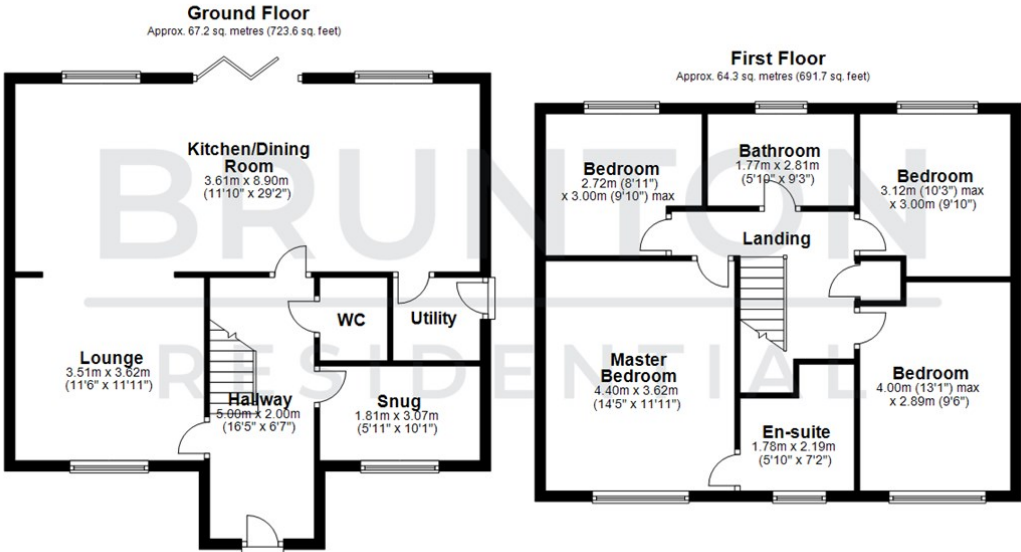

All measurements are approximate and are for illustration only.
Plan produced using PlanUp.



Energy Efficiency Rating		
	Current	Potential
Very energy efficient - lower running costs		
(92 plus) A		
(81-91) B		
(69-80) C		
(55-68) D		
(39-54) E		
(21-38) F		
(1-20) G		
Not energy efficient - higher running costs		
England & Wales		EU Directive 2002/91/EC

Environmental Impact (CO ₂) Rating		
	Current	Potential
Very environmentally friendly - lower CO ₂ emissions		
(92 plus) A		
(81-91) B		
(69-80) C		
(55-68) D		
(39-54) E		
(21-38) F		
(1-20) G		
Not environmentally friendly - higher CO ₂ emissions		
England & Wales		EU Directive 2002/91/EC